

1



Dikmeler bantlıdır. Bantlarını açınız.  
Bantlanan parçaları ayırınız.

Prepare the bracket for mounting

2

6x80

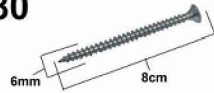

Zemin üzerinde ürünün montaj  
yapılacak yerleri belirleyip L  
bağlantıları zemine 6x80 vida  
ile vidalayınız.

Mount the product using L connection  
and 6x80 screw on floor.

5

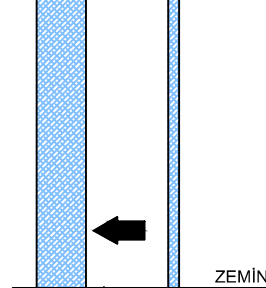
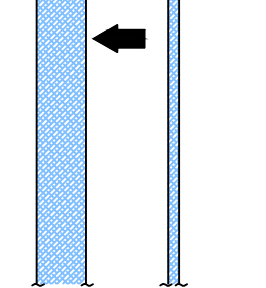
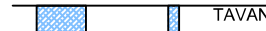
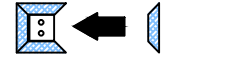

1. kutuyu bağladıktan sonra  
kutunun 4. parçasını wwurt  
yardımı ile yapıştırınız.

After connecting the first box, paste  
the 4th piece of the box.

6

MONTAJ ŞEMASI  
Assembly Instruction

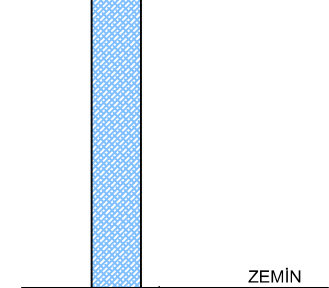
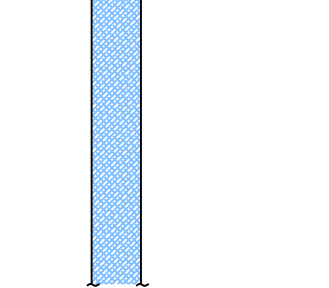
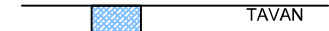

Diğer dikmelerinde  
montajına devam ediniz.

Continue the same process in  
other parts and complete the installation

ÖLÇÜLER: cm (santimetre'dir)  
Measurements are in cm.

3

4x18

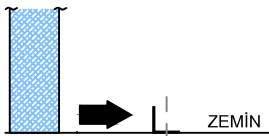
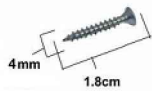

Dikmeleri L bağlantıya geçirip  
4x18 vida ile vidalayınız.

Fix the posts to L connection and  
with 4x80 screws

4



Bu işlemi aynı şekilde tavan  
kısmında da uygulanacaktır.

This process will be applied in the  
same way for ceiling aswell.

ÜRÜN ADI:  
Name of product :

WOOD WALL

ÇİZEN:  
Designer:

DUYGU İLKHAN

TARİH  
Date